

Diamond Interchange Alignment Controls

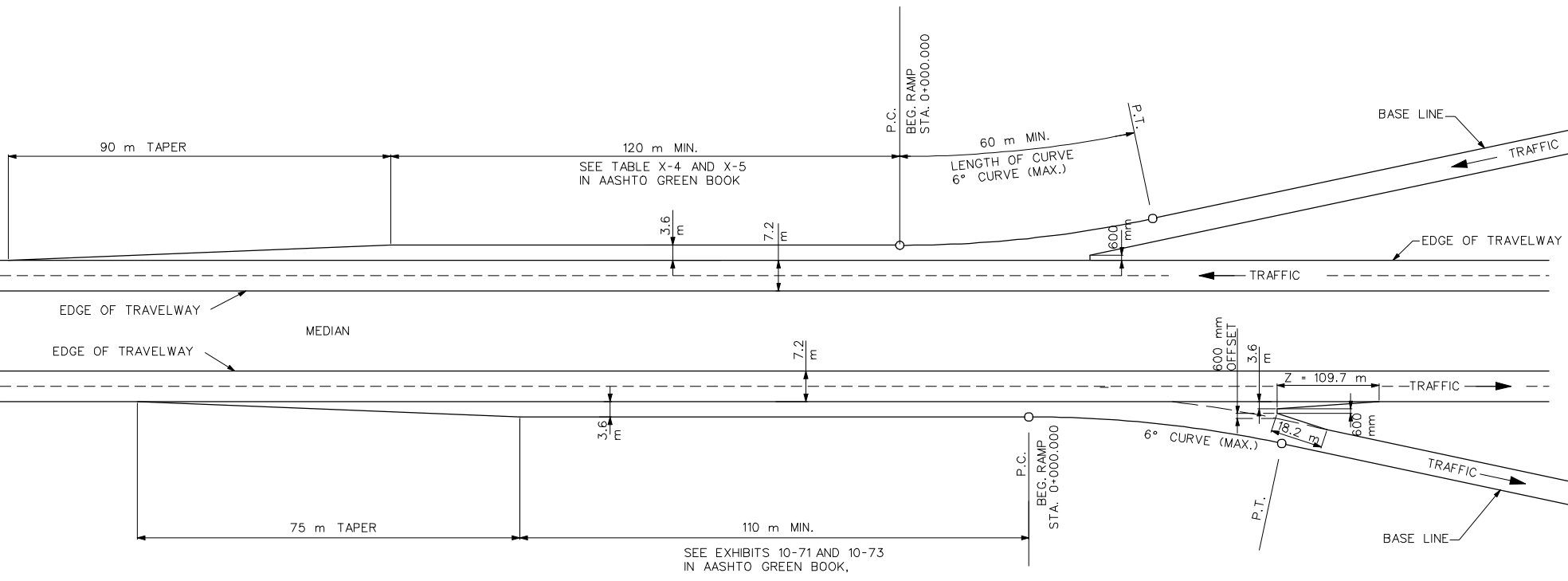

Diamond Interchange Alignment Controls

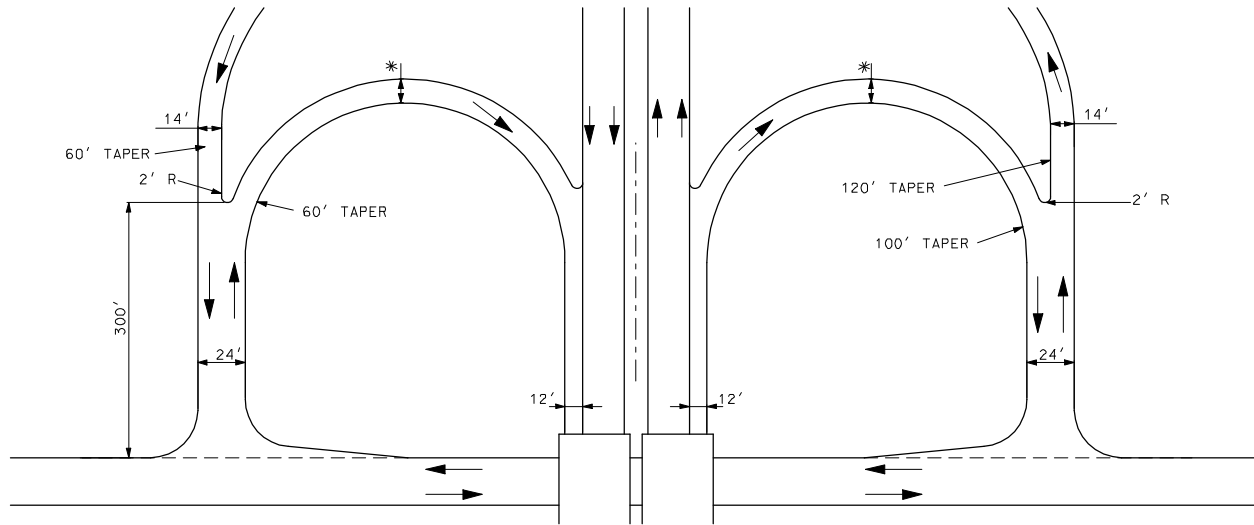

2-LANE MINOR ROAD

* 18' WHEN RADIUS IS $\geq 400'$
 * 22' WHEN RADIUS IS $< 400'$

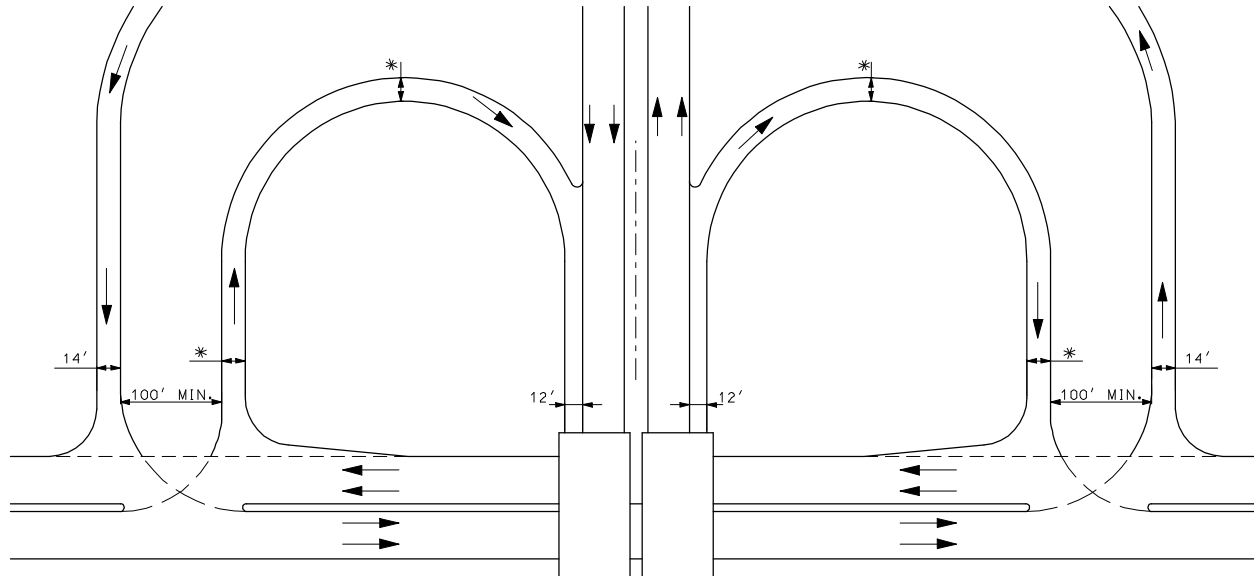

4-LANE MINOR ROAD

Folded Diamond-Type Interchange

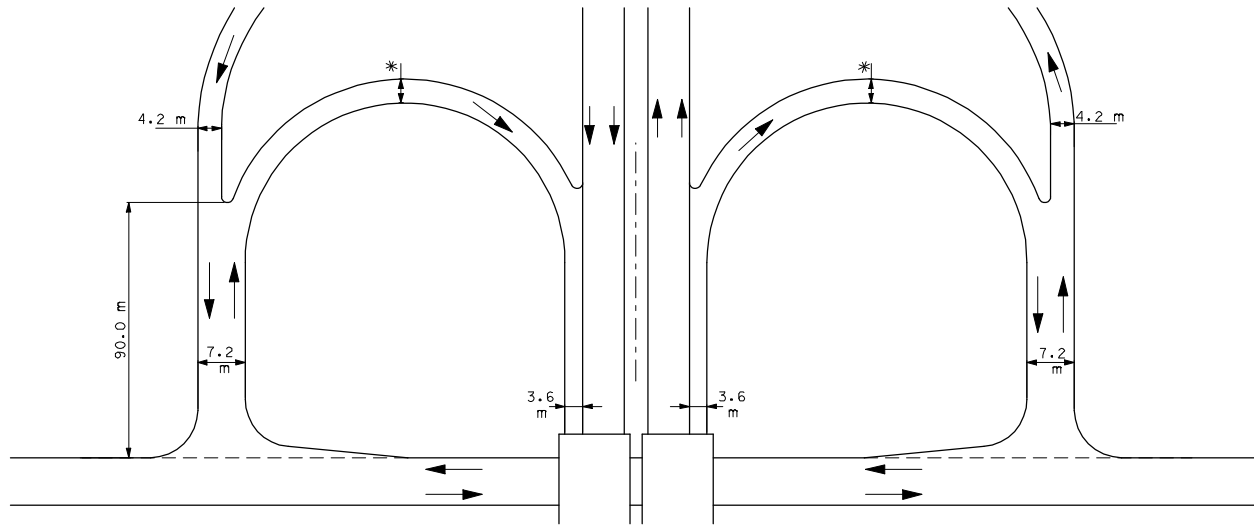

2-LANE MINOR ROAD

* 5.4 m WHEN RADIUS IS ≥ 120 m
 6.6 m WHEN RADIUS IS < 120 m.

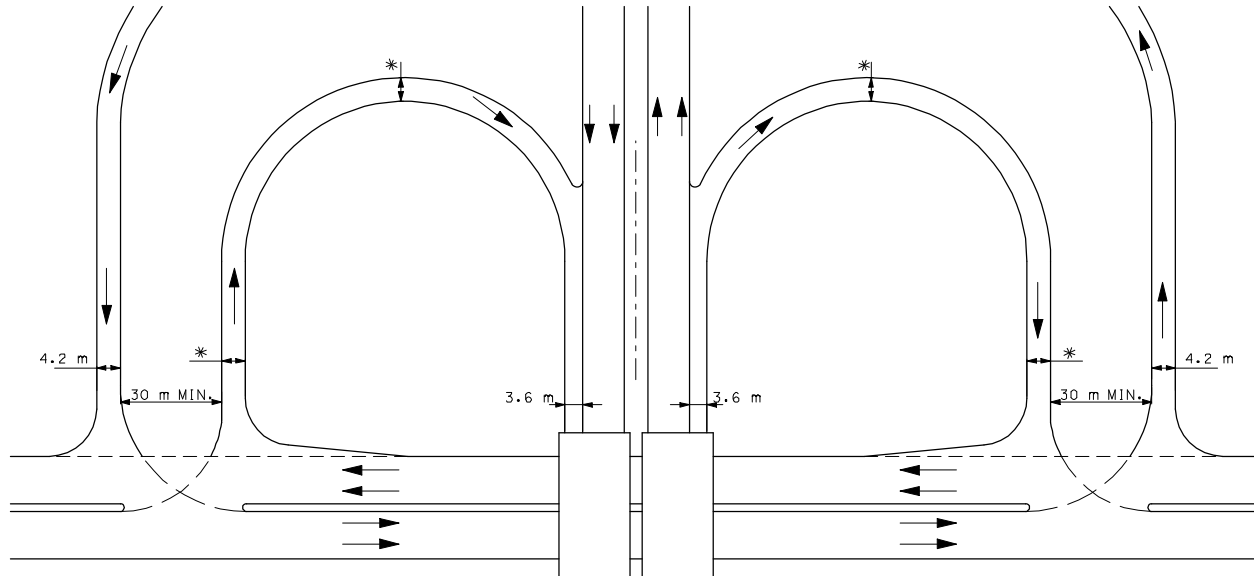

4-LANE MINOR ROAD

Folded Diamond-Type Interchange

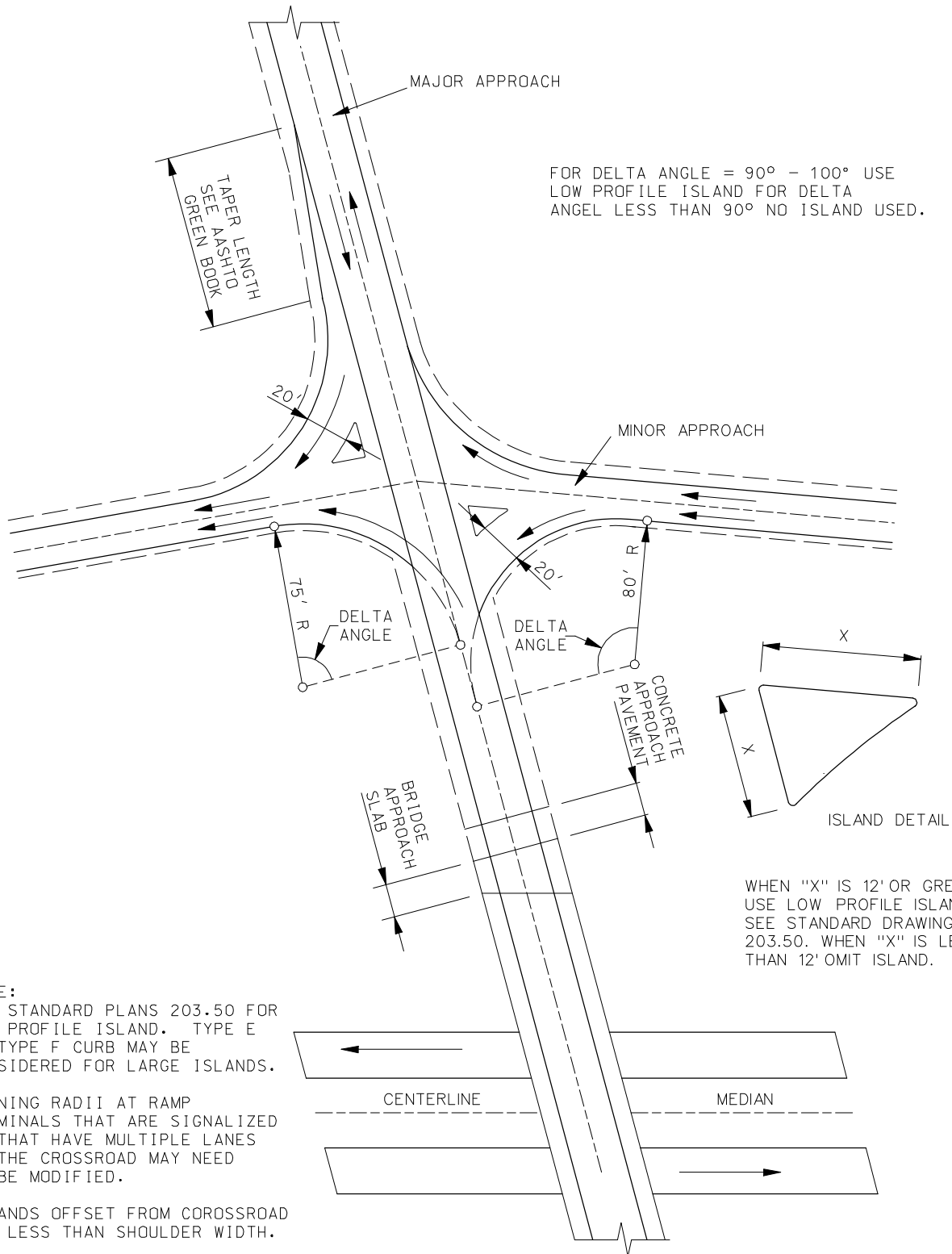

Geometries of Diamond Interchanges - Ramp Termini

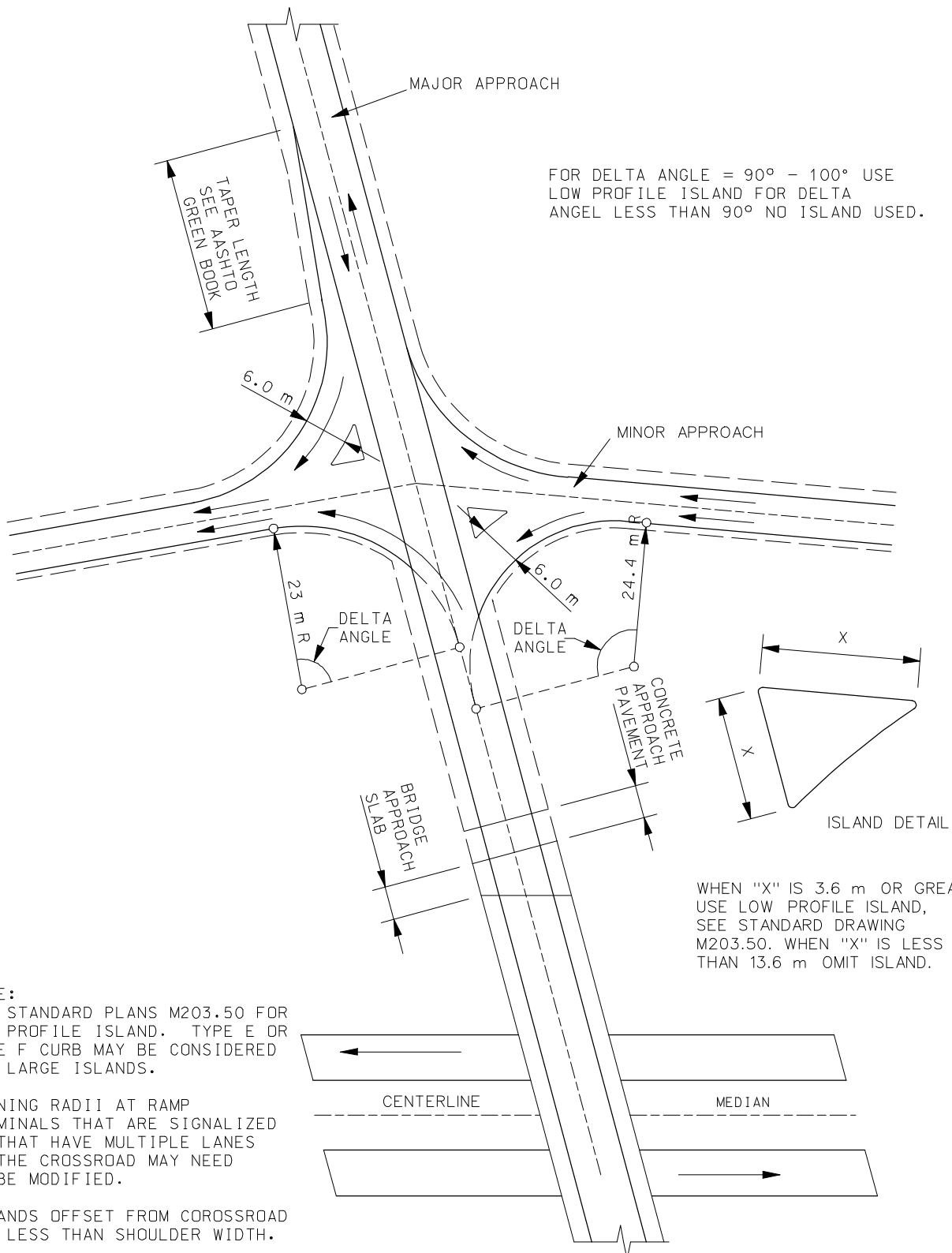

FOR DELTA ANGLE = 90° - 100° USE
LOW PROFILE ISLAND FOR DELTA
ANGEL LESS THAN 90° NO ISLAND USED.

WHEN "X" IS 3.6 m OR GREATER,
USE LOW PROFILE ISLAND,
SEE STANDARD DRAWING
M203.50. WHEN "X" IS LESS
THAN 13.6 m OMIT ISLAND.

NOTE:
SEE STANDARD PLANS M203.50 FOR
LOW PROFILE ISLAND. TYPE E OR
TYPE F CURB MAY BE CONSIDERED
FOR LARGE ISLANDS.

TURNING RADII AT RAMP
TERMINALS THAT ARE SIGNALIZED
OR THAT HAVE MULTIPLE LANES
ON THE CROSSROAD MAY NEED
TO BE MODIFIED.

ISLANDS OFFSET FROM COROSSROAD
NOT LESS THAN SHOULDER WIDTH.

FOR SIGHT DISTANCE AT RAMP
TERMINALS, SEE CHAPTER 9,
AASHTO GREEN BOOK.

Geometries of Diamond Interchanges - Ramp Termini

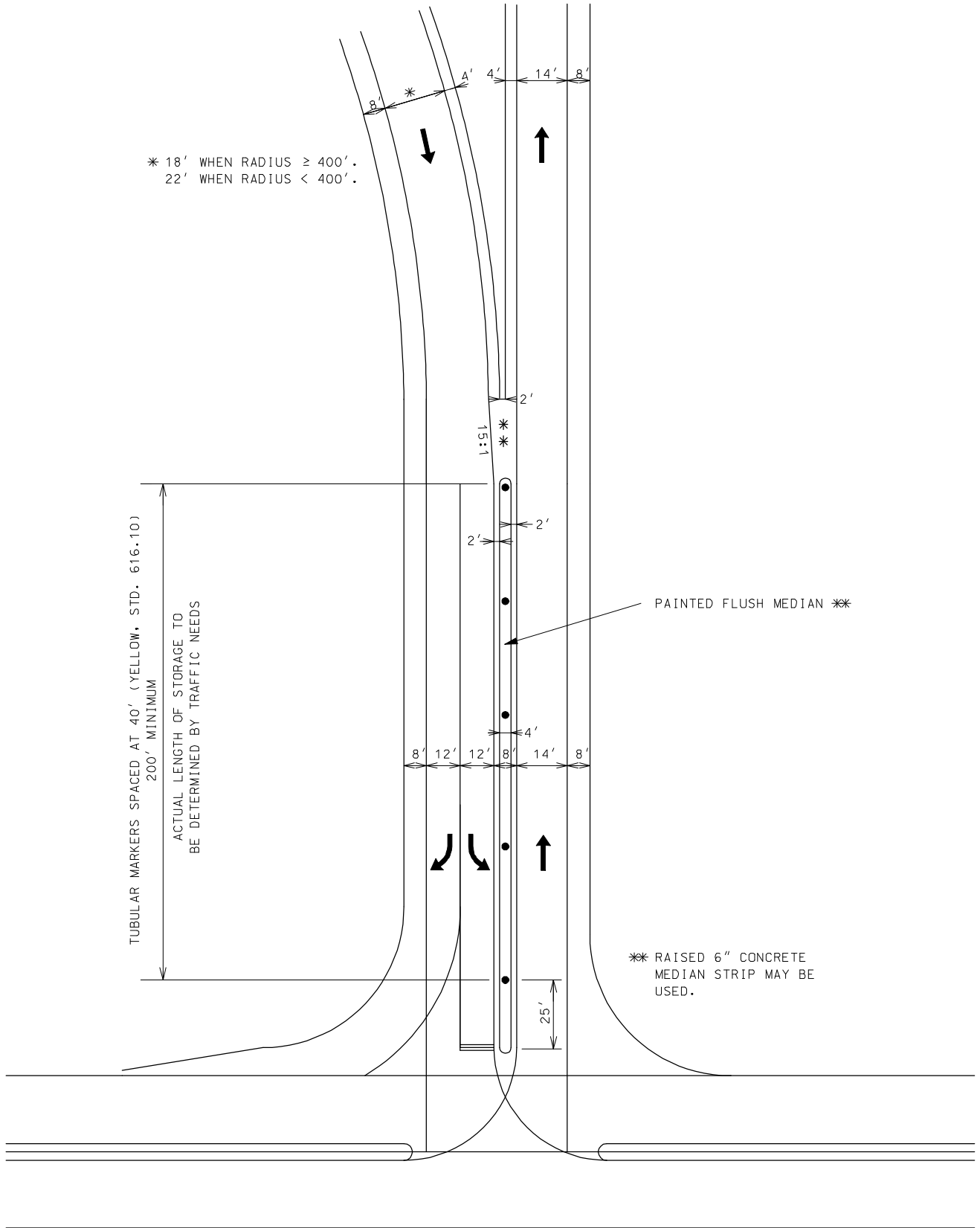

Folded Diamond Intersection Details

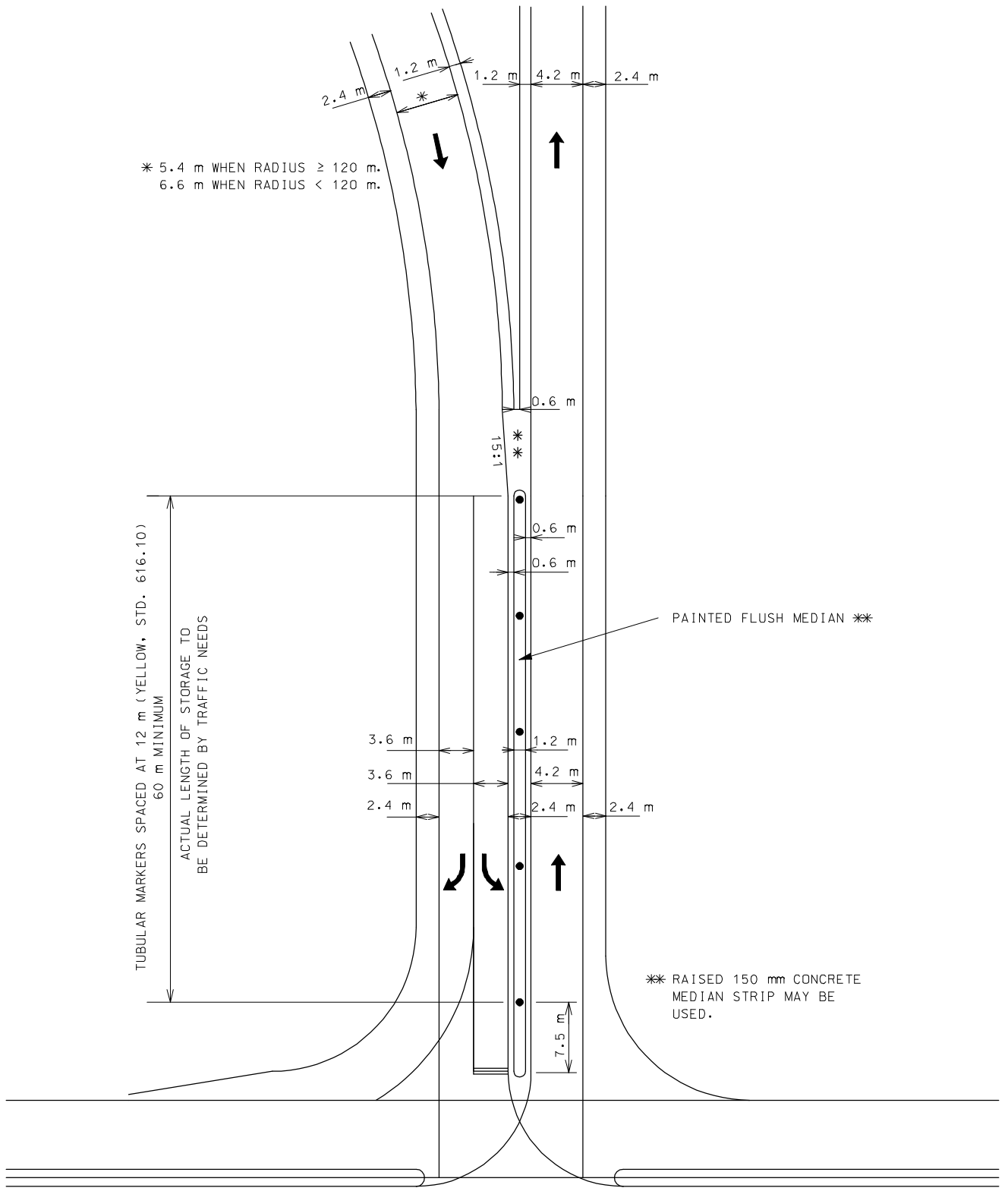

Folded Diamond Intersection Details