

**KEEP  
RIGHT**

\*TWO ADDITIONAL "TWO WAY TRAFFIC" SIGNS SHALL BE ERECTED AT 3 MILES AND 5 MILES FROM THE POINT WHERE THE TWO CENTERLINES MEET (OR END OF DIVIDED HIGHWAY) WHEN THE FOLLOWING CONDITIONS EXIST:

(1) THE SECTION OF DIVIDED HIGHWAY EXCEEDS 2MILES IN LENGTH.

(2) THE HIGHWAY IS PLANNED FOR CONTINUOUS OR NEARLY CONTINUOUS DIVIDED PAVEMENT



\*\*CONFIRMING MARKER

**KEEP  
RIGHT**

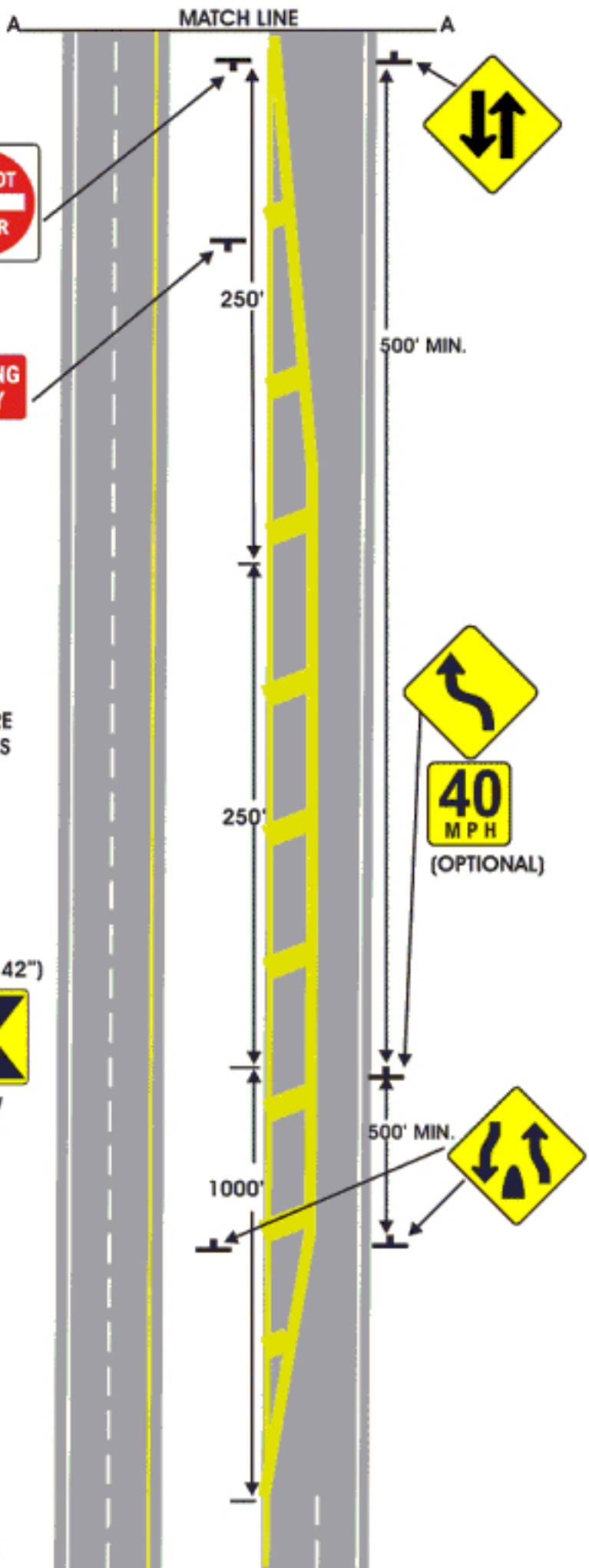
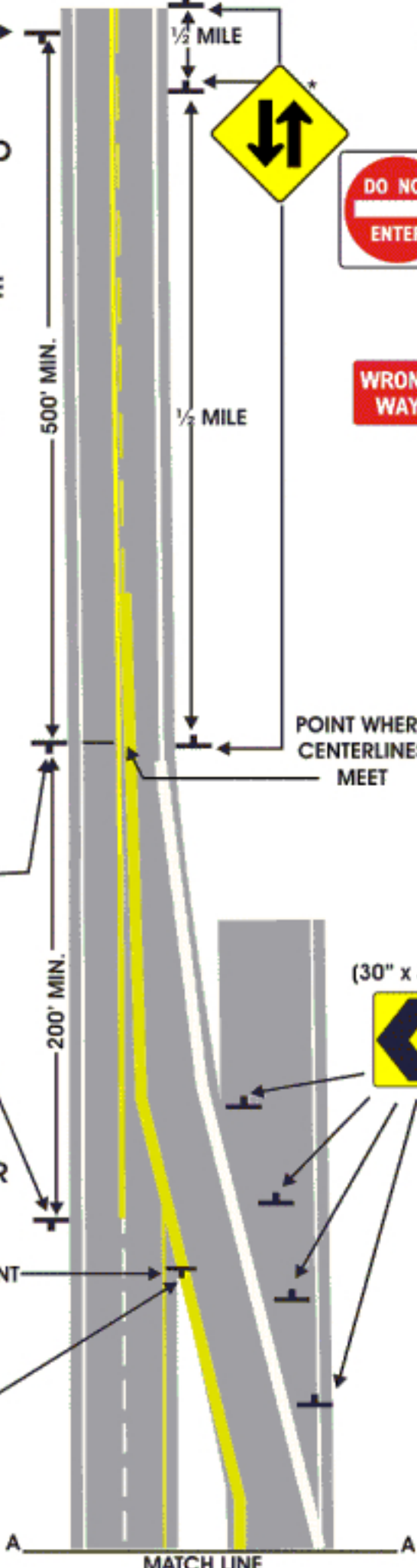

MATCH LINE