

Example Grade Separation Plan

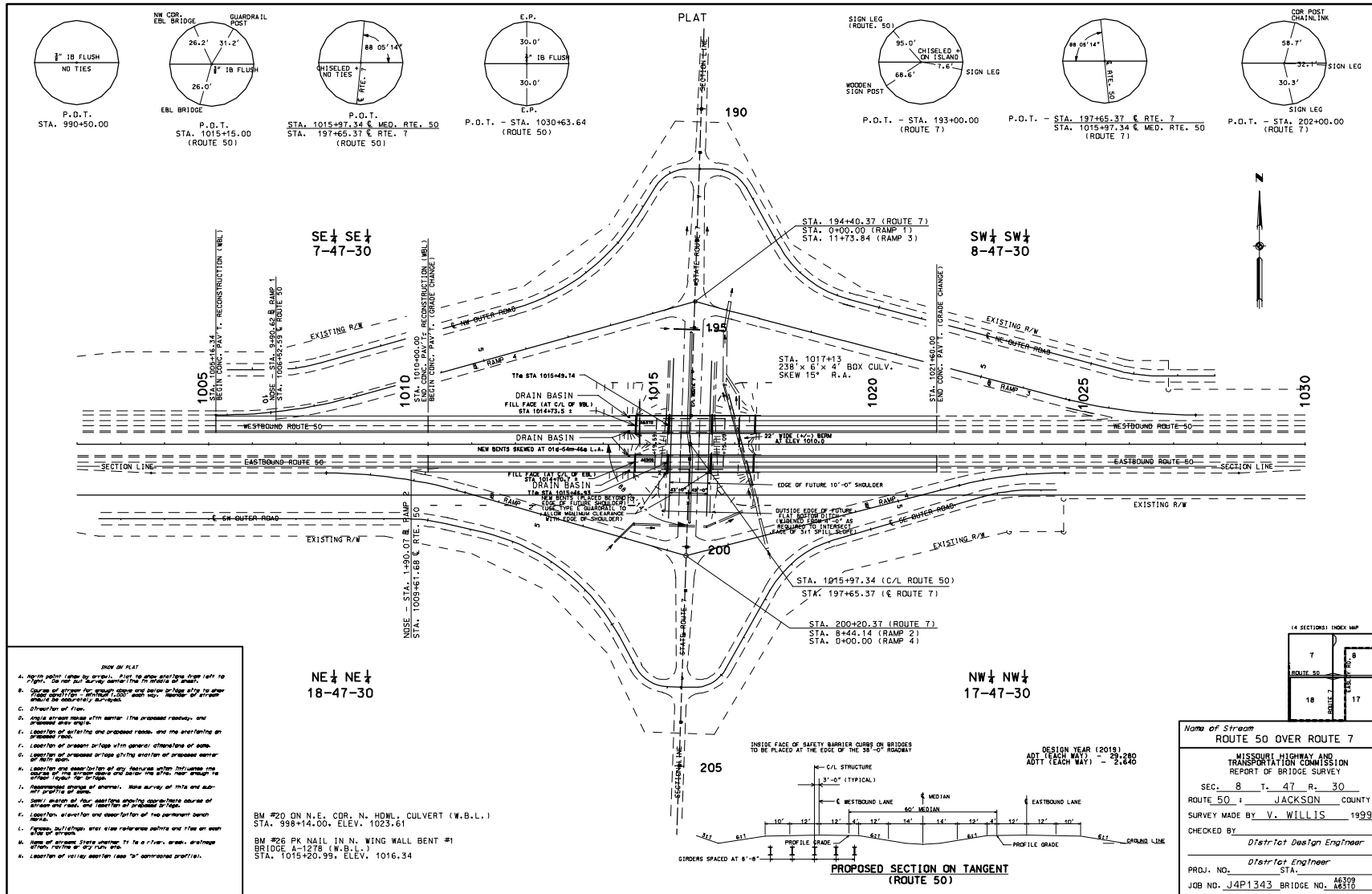

- SHOW ON PLAN**
- A. Marked points shown by symbols. Plan to show stationing along left to right, do not show stationing on the right side of road.
 - B. Change of stationing for proposed roads and show on plan with the same symbol as existing roads. Do not show stationing on the right side of road.
 - C. Direction of flow.
 - D. Angle across roads with center line proposed roads, and proposed road angle.
 - E. Location of existing and proposed roads, and the existing or proposed road.
 - F. Location of proposed bridge with general dimensions of same.
 - G. Location of proposed bridge with the stationing of proposed center of bridge.
 - H. Location and stationing of any structure which indicates the stationing of the bridge spans and center line of the road.
 - I. Dimensioned grade of stream. Note survey of this and submit profile of same.
 - J. Center station of the mainline showing approximate course of stream and road, and location of proposed bridge.
 - K. Name of stream, State number if in a river, stream, drainage district, or city name.
 - L. Name of stream, State number if in a river, stream, drainage district, or city name.
 - M. Location of valley bottom line to approximate profile.

BM #20 ON N.E. COR. N. HOWL. CULVERT (W.B.L.)
 STA. 998+14.00, ELEV. 1023.61

BM #26 PK NAIL IN N. WING WALL BENT #1
 BRIDGE A-1278 (W.B.L.)
 STA. 1015+20.99, ELEV. 1016.34

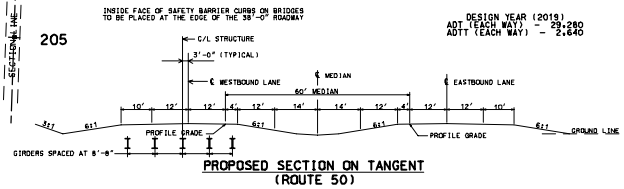

DESIGN YEAR (2019)
 ADT (TEACH WAY) - 29,280
 ADT (TEACH WAY) - 2,240

Name of Stream	
ROUTE 50 OVER ROUTE 7	
MISSOURI HIGHWAY AND TRANSPORTATION COMMISSION REPORT OF BRIDGE SURVEY	
SEC. 8	T. 47 R. 30
ROUTE 50 JACKSON COUNTY	
SURVEY MADE BY V. WILLIS 1999	
CHECKED BY	
District Design Engineer	
District Engineer	
PROJ. NO.	STA.
JOB NO. J4P1343	BRIDGE NO. A630